

8080 Series

Warm White Lens

High Power LED Sunnix6™



SLHNNWW629T1

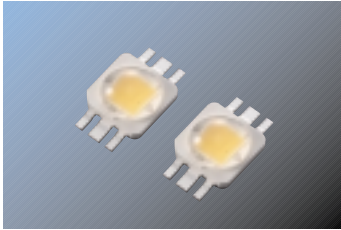

Radiation Diagram(120°)

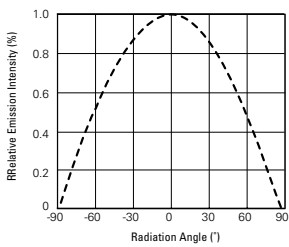

Package Outline

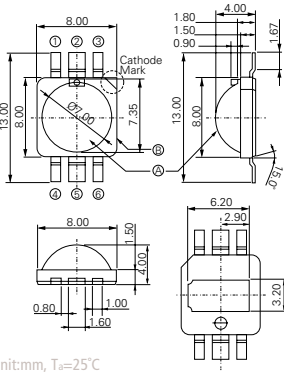

Polarity

Recommended Soldering Pattern

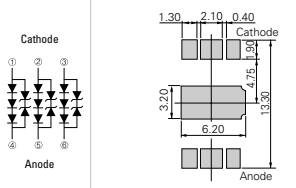

Carrier Tape

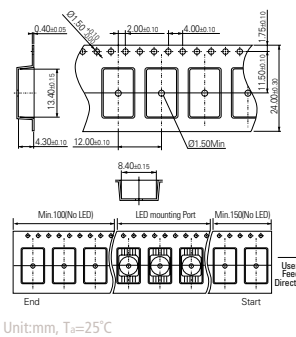

Absolute Maximum Ratings T_a=25°C

Item	I _F (mA)	T _J (°C)	T _{Stg} (°C)	T _{Sld}	T _{Opr}
Value2	180	120	-40 ~ 110	260°C, 10sec	-40 ~ 85

Electrical Characteristics T_a=25°C

Item	Symbol	Condition	Min.	Typ.	Max.	Unit
Forward Voltage	V _F	I _F =180mA	8.9	9.7	11.0	V
Reverse Voltage	V _R	I _F =10mA	12.0	-	16.5	

※ Tolerance : V_F ±0.1V

Chromaticity Coordinate T_a=25°C, @180mA

Rank	CCx				CCy				CCT
S0	0.3428	0.3700	0.3863	0.3471	0.3138	0.3322	0.4050	0.3818	4,000~5,000
T0	0.3700	0.4370	0.3863	0.3700	0.3322	0.3551	0.4310	0.4050	3,300~4,000
U0	0.4041	0.4440	0.4880	0.4370	0.3551	0.3700	0.4490	0.4310	2,600~3,300

※ Tolerance: x,y ±0.02

Part Number	Dimension (mm)	Rank	Luminous Flux (lm)			Condition	CRI	Viewing Angle 2θ1/2(degree)
			Min.	Typ.	Max.			
SLHNNWW629T1	8.0 × 8.0 × 3.9t	S0	80	123*	150	180mA	85	120 °

※ Tolerance ±10%
 ※ 110lm @ 2,600 - 3,200K

Relative Luminous Flux vs Forward Current

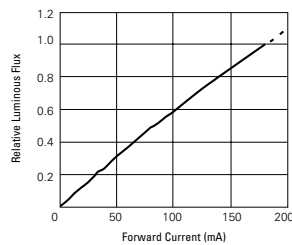

Forward Current vs. Forward Voltage

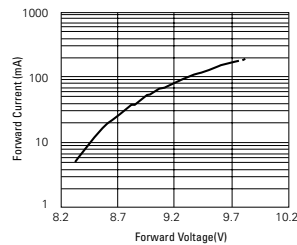

Spectrum Distribution

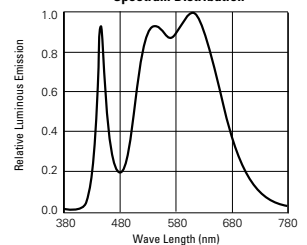

Derating Curve for 120mA

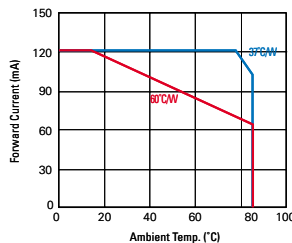

Derating Curve for 180mA

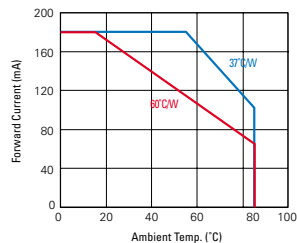

CIE Coordinate

